

BOLD GREEN numbers = stock item
LIGHT RED numbers = special order item



BOLD GREEN numbers = stock item
LIGHT RED numbers = special order item

SAIL NUMBERS

Sail No.

0	3410F
1	3411F
2	3412F
3	3413F
4	3414F
5	3415F
6	3416F
7	3417F
8	3418F
9	3416F

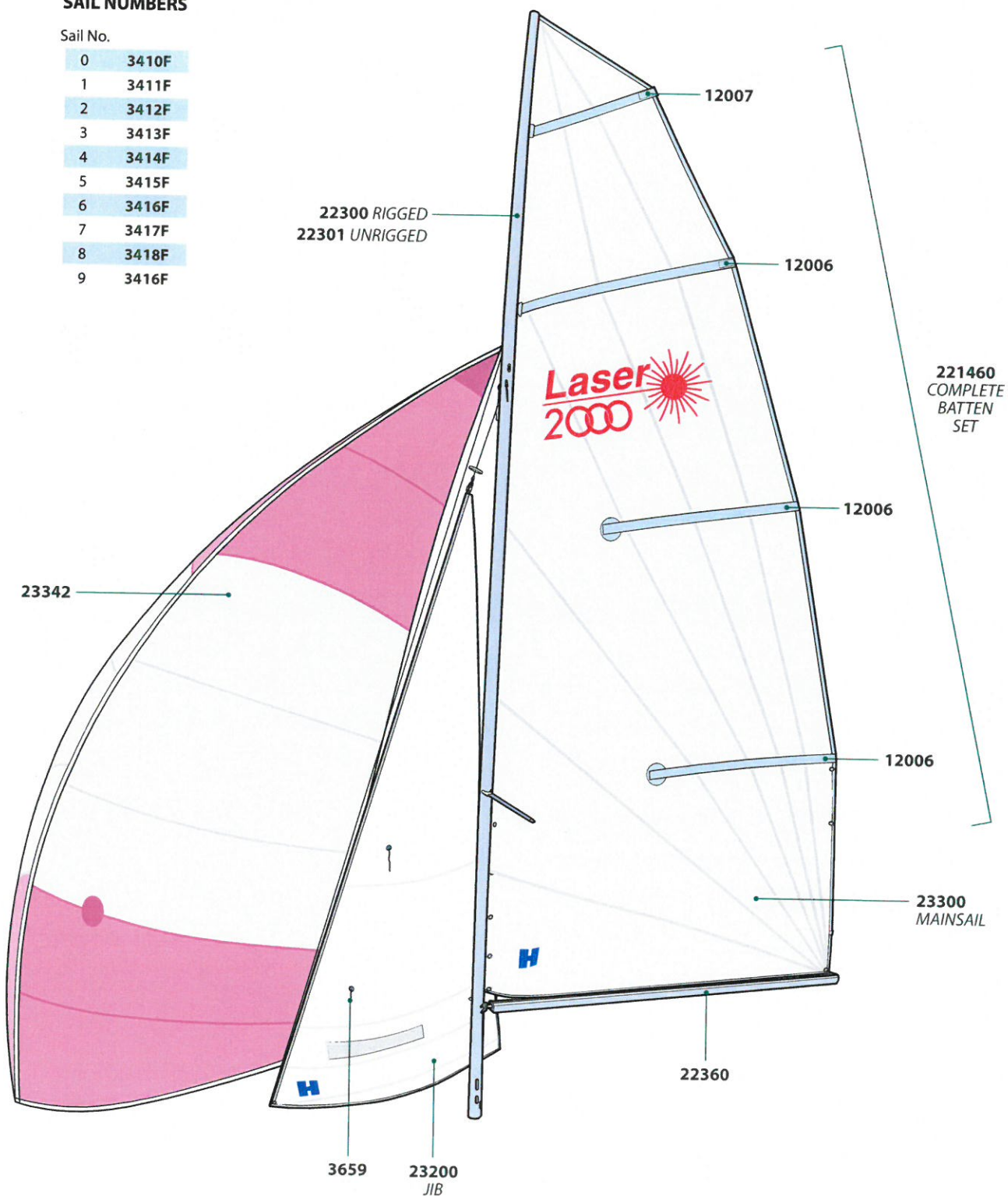

BOLD GREEN numbers = stock item
LIGHT RED numbers = special order item

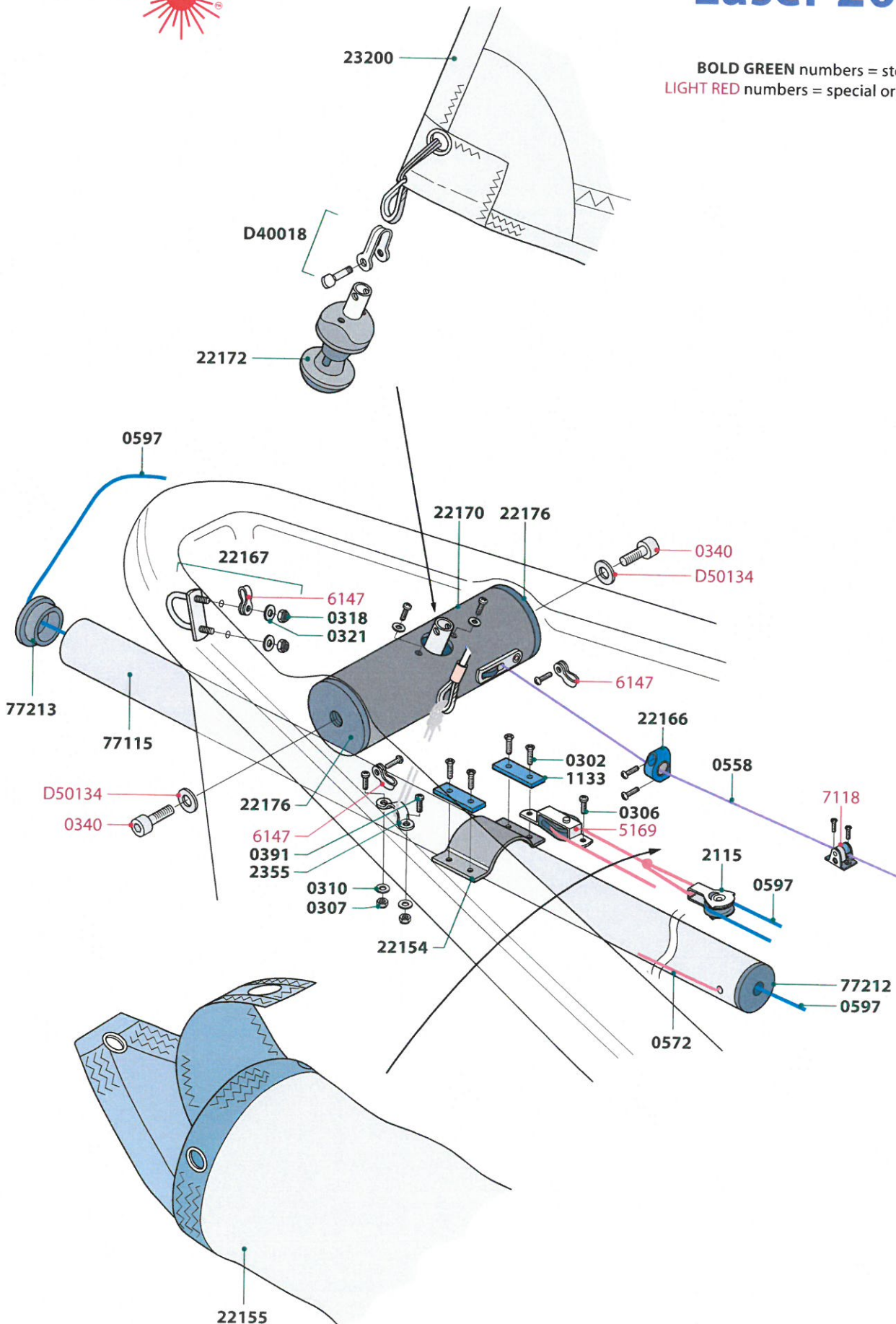

BOLD GREEN numbers = stock item
LIGHT RED numbers = special order item

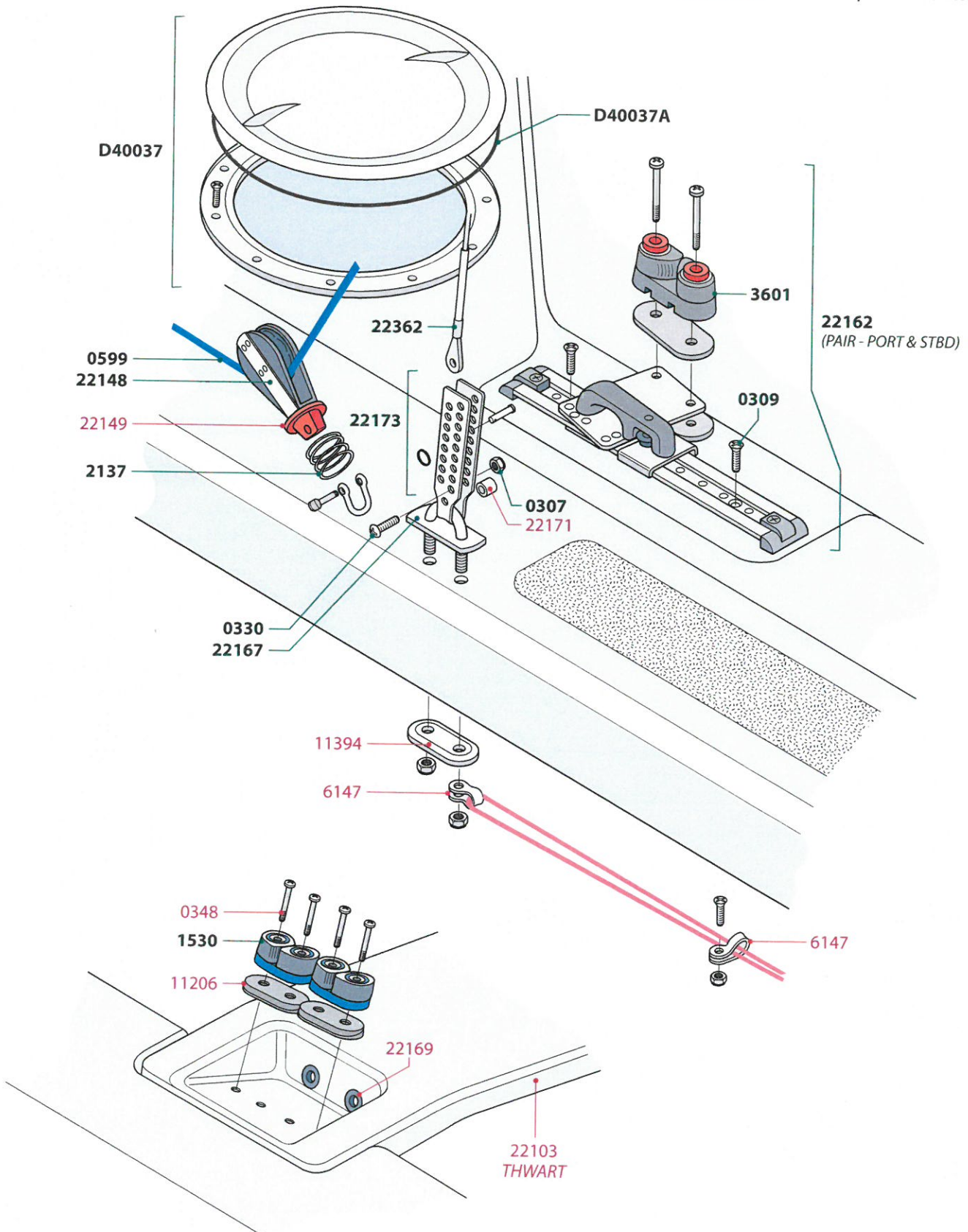

IMPORTANT NOTICE: All diagrams, drawings and related information are the intellectual property of Performance Sailcraft Europe Limited. Any copying, distributing or other use without our prior written permission is strictly prohibited. © 2006 Performance Sailcraft Europe Limited.

BOLD GREEN numbers = stock item
LIGHT RED numbers = special order item

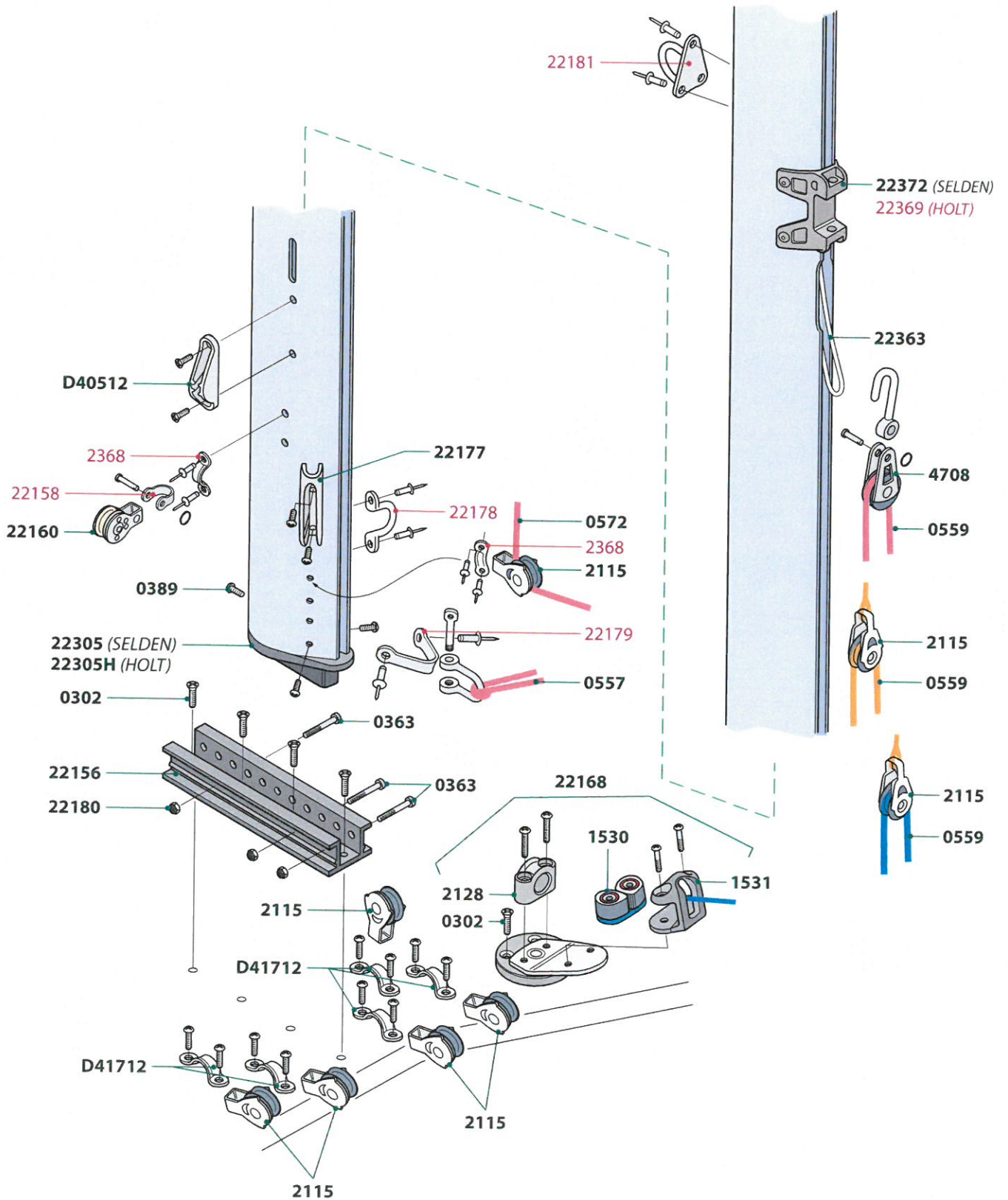

IMPORTANT NOTICE: All diagrams, drawings and related information are the intellectual property of Performance Sailcraft Europe Limited. Any copying, distributing or other use without our prior written permission is strictly prohibited. © 2006 Performance Sailcraft Europe Limited.

BOLD GREEN numbers = stock item
LIGHT RED numbers = special order item

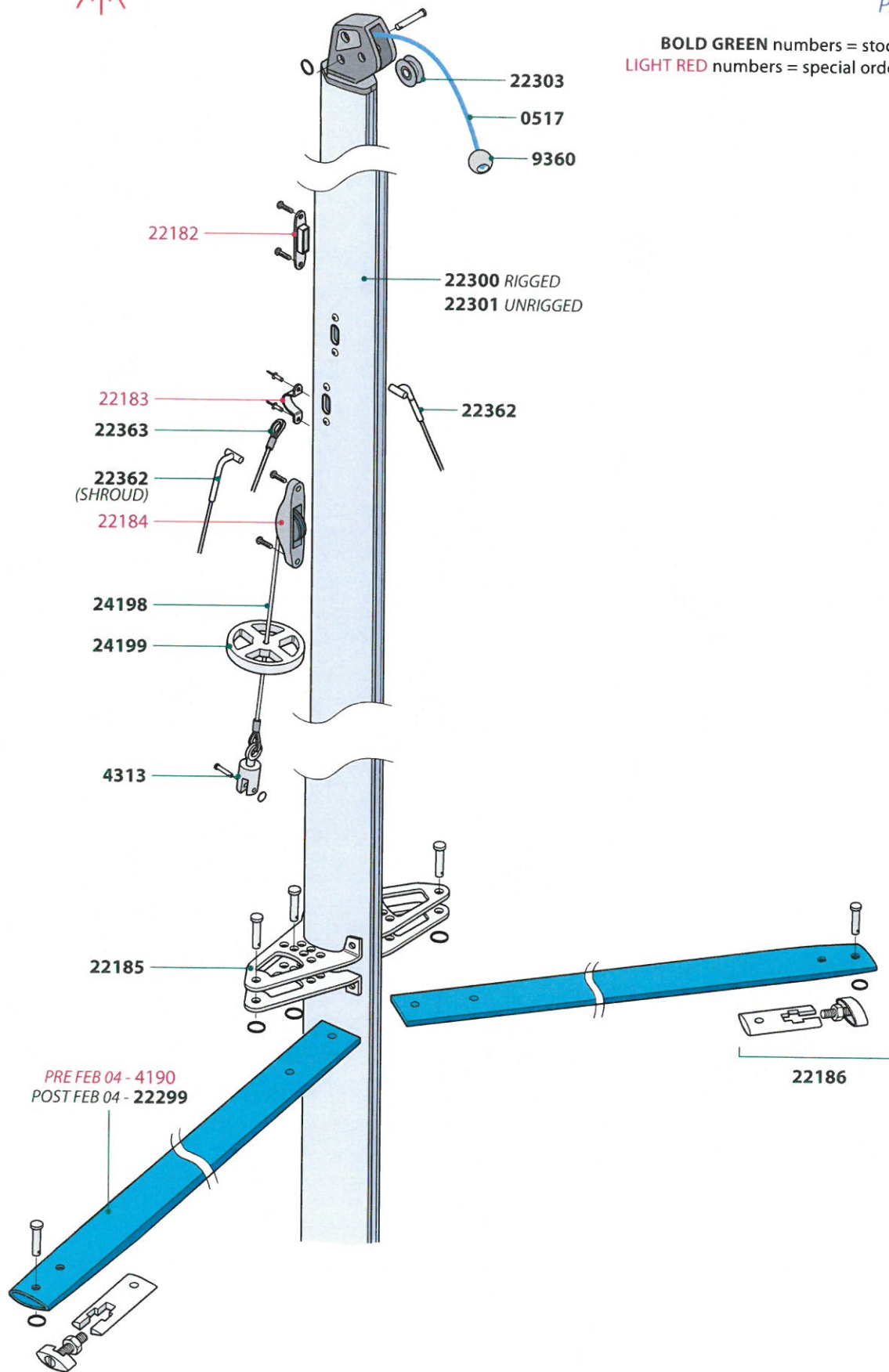

BOLD GREEN numbers = stock item
LIGHT RED numbers = special order item

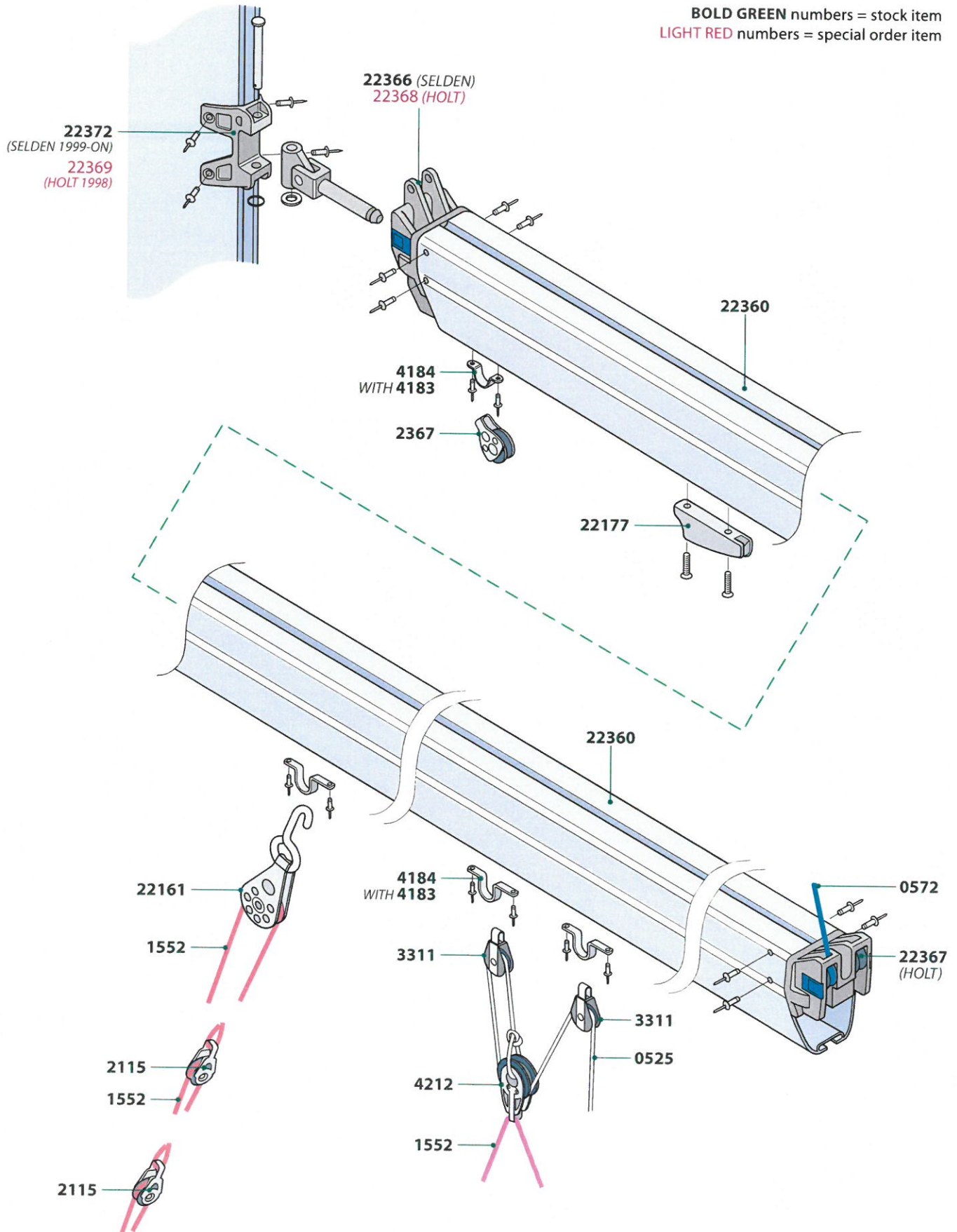

IMPORTANT NOTICE: All diagrams, drawings and related information are the intellectual property of Performance Sailcraft Europe Limited. Any copying, distributing or other use without our prior written permission is strictly prohibited. © 2006 Performance Sailcraft Europe Limited.

BOLD GREEN numbers = stock item
LIGHT RED numbers = special order item

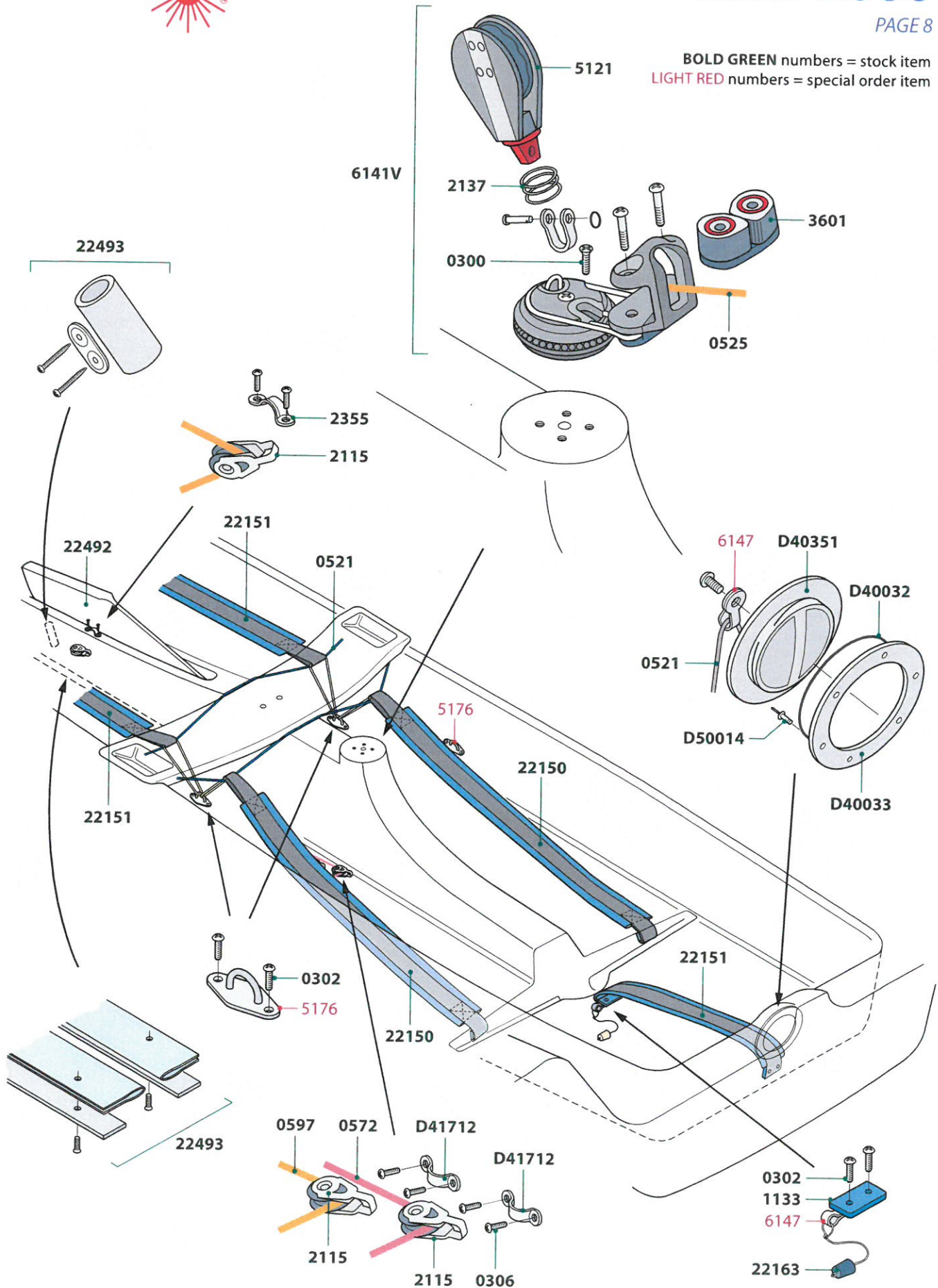

IMPORTANT NOTICE: All diagrams, drawings and related information are the intellectual property of Performance Sailcraft Europe Limited. Any copying, distributing or other use without our prior written permission is strictly prohibited. © 2006 Performance Sailcraft Europe Limited.

BOLD GREEN numbers = stock item
LIGHT RED numbers = special order item

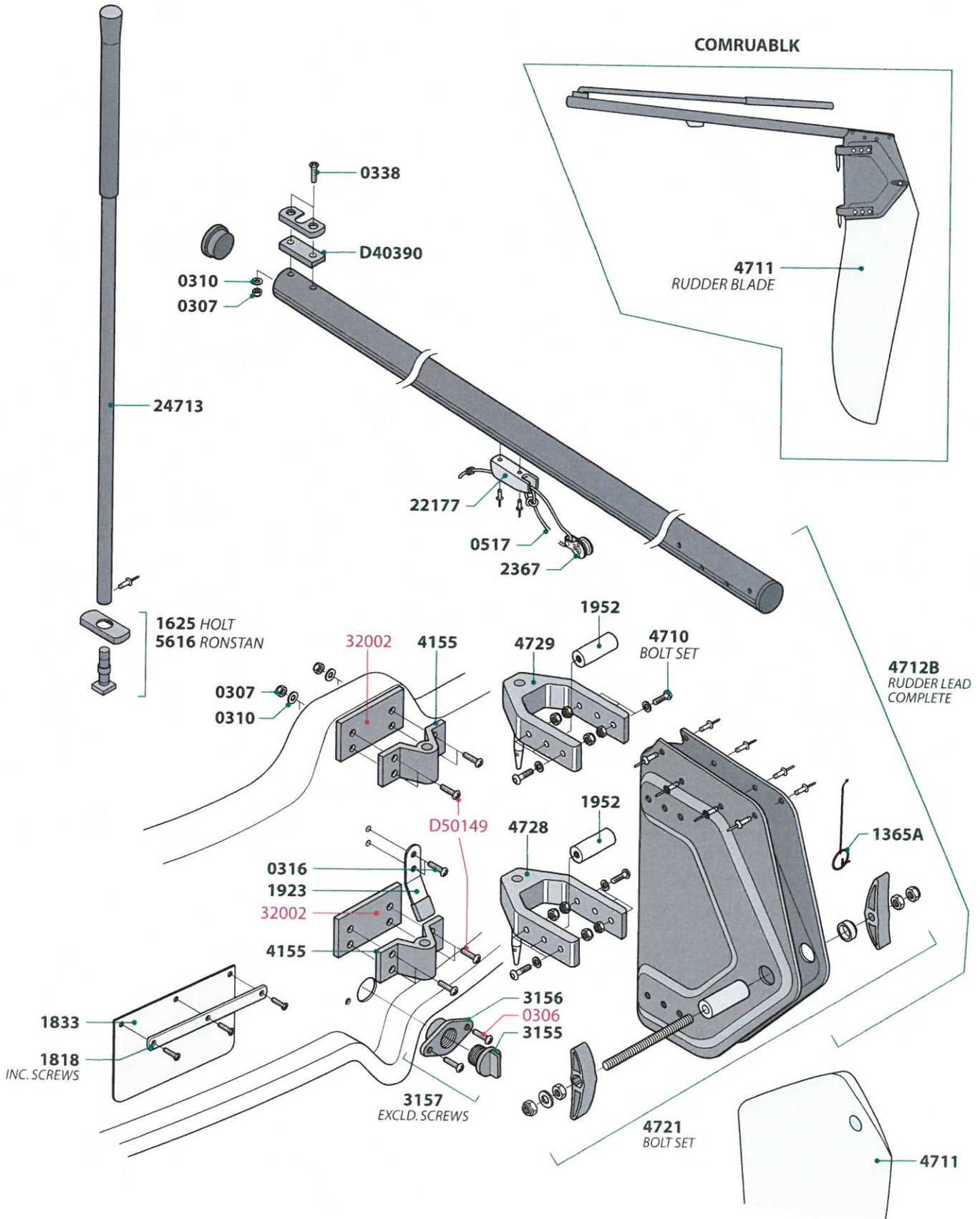

IMPORTANT NOTICE: All diagrams, drawings and related information are the intellectual property of Performance Sailcraft Europe Limited. Any copying, distributing or other use without our prior written permission is strictly prohibited. © 2006 Performance Sailcraft Europe Limited.

Laser 2000 Tuning & Settings

Objectives

1. Maximise power whilst keeping rig under control and balanced
2. Create an efficient sail shape by altering tensions on the edges of the sails
3. Create optimum compromise between speed and pointing for upwind sailing

Leeches	Open Leeches	Tight Leeches
	Acceleration and speed good Pointing compromised	Risk of (wind) stalling Good pointing
Sails	Full Sails	Flat Sails
	Good power Pointing compromised	Reduced power Good pointing

Sail and leech settings basics

Wind Condition	General Setting	Rationale
Light	Flat sails & Open leeches	Avoid stalling of wind across sail
Medium	Full sails & Tight leeches	To give power and pointing
Strong	Flat sails & Tight(ish) leeches	Reduce power and maintain pointing

Effect of controls

Wind Condition	Effect	Comments
Kicker	Controls main leech Bends mast (flattening main)	

Cunningham	Controls main draught position - flattens main Opens main leech	
Outhaul	Flattens bottom third of sail	
Rig tension	Controls jib luff sag & leech profile Effects mast rake	Aim to keep leeward shroud just tight
Jib tracks	Controls jib leech.	Ensure enough tension so that telltales break at the same time.
Main strop	Effects leech tension.	Raise in light weather; lower in windy weather

Set Up Guide for Different Wind Conditions

Wind	Main Sail	Jib
Light (Underpowered)	Flatten mainsail with some outhaul (avoid stalling) Keep kicker eased	Ease rig tension Move tracks back
Medium (Full power)	Power up by easing outhaul Tighten leech via kicker Ease cunningham (or OFF)	Increase rig tension
Strong (Overpowered)	Depower by tighter outhaul Tighten leech via kicker Apply cunningham Raise centreboard a little	Open leech by moving tracks back Even higher rig tension

Take care of closed slot between main and jib cause by tight jib leech or over-full / eased main.

When sailing upwind in breezy conditions be sure to release kicker and cunningham **before** bearing away otherwise it may be difficult to effect manoeuvre.

Simple Reference Summary (for upwind sailing)

Wind	Rake*	Tension	Jib tracks	Kicker	Cunningham	Main strops	Outhaul
Medium Fully powered	6560mm	300 lbs	back	on medium	off	neutral position	100mm depth
Light. Under powered	6560mm	< 300 lbs	centre	off	on	High	50mm depth
Heavy Over powered	6560mm	340 lbs	back	on hard	on hard	low	full on

*Rake - measured top of mast to top of rudder post. One shroud pin hole down increases rake by about 40mm. Line between spreaders to mast = 165-175mm (about 860mm tip to tip).

*Some suggest increasing rake in heavy wind conditions via moving one whole shroud pin down from medium default setting. Raking back 2 holes from medium default setting is roughly equivalent to one reef in the mainsail and could make boat manageable in very strong winds.

*It is suggested that one does not focus excessively on rig and rake setting. Medium rig tension and rake should be good enough for almost all occasions - there are so many other factors than straight boat speed. Instead concentrate on more important issues such as boat handling, tide, tactics and making fewer mistakes.

Sources: Weir Wood Sailing Club tuning guides. Pete Harrison.